



# SL-TL25



# Introduction



◀ LED Track light adopts Citizen LEDs with excellent color rendering index to increase the color fidelity of the target illuminated object. Providing excellent heat dissipation, even light output without glare & dark spot. Adjustable lighting orientation with 360 degree in horizontal direction and 180 in vertical direction provided. 1-circuit adapter, 3-circuit adapter offered for wide choice. Dimming button on the bottom of the track light.

## Features

1. Up to 70% energy saving compared to standard CFL.
2. Long lifetime of 40,000 hours.
3. CCT: 2700K 3000K 4000K 5000K
4. No UV/IR light Environment friendly, without Mercury or any other hazardous substances.
5. IP20 for indoor use only.

## Application Areas

It is suitable for supermarket, specialty store, show window, exhibition hall; focus lighting, decorative and background lighting, where attention is focused on subjects to emphasize special visual points.



Dimmable button

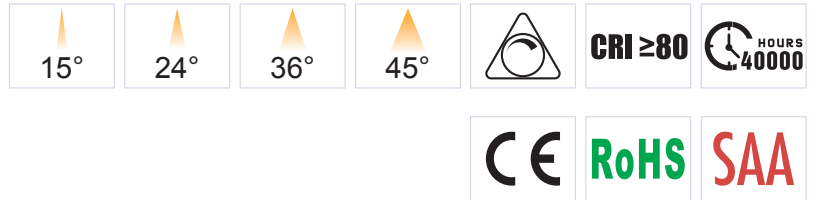
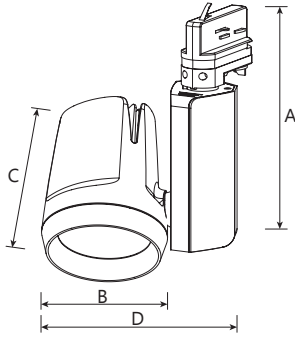

## Measurement

Model	Dimension(mm)				Size(mm)	Product Weight (Kg)		Package weight (Kg)		Carton Size(cm)	Qty/CTN	20GP (pcs)	40HQ (pcs)
	A	B	C	D		N.W/PC	G.W/PC	N.W/CTN	G.W/CTN				
15W	170	83	68	102	170*102*83	0.38	0.42	6.84	9	46*46*35	18	6480	15750
25W	215	118.5	90	146	215*146*118.5	0.68	0.72	8.16	9.5	53*39*41	12	3360	8352
35W / 45W	215	128	105	161	215*161*128	0.85	0.92	10.2	11.8	54*42*47	12	3120	6480

## Technical Data Sheet

Model No.	TL25-15W		TL25-25W		TL25-35W		TL25-45W	
Watt(W)	15W		25W		35W		45W	
Dimension(mm)	170*102*83		215*146*118.5		215*161*128			
Rated Input Voltage(V)	AC230V							
Input Voltage(V)	AC220-240V							
LED	COB							
SDCM	-							
CCT(K)	1 CCT: 2700K / 3000K / 4000K / 5000K							
"Luminous Flux (lm) ±5%"	1-CCT	Non-DIM	1320-1470	2350-2600	3400-3600	3990-4410		
		DIM	1290-1440	2250-2550	3230-3420	3860-4280		
CRI	80							
Beam Angle (°)	24° / 45°			15° / 24° / 36°				
LED Driver	Built-in							
DIM	Yes							
Protection Class	Class I							
IP Rating	IP20							
IK Rating	-							
Finishing color	White RAL 9003 / Black RAL 9005							
Material	PC / Aluminium							
Lifetime (hr)	40,000h							
Glow wire test (°C)	750°C							
Operating Temp.(°C)	-20°C ~45°C							
Storage Temp.(°C)	-20°C ~65°C							
Installation	Track							
Brand Driver option	-							

## Driver Datasheet (Non-Dimmable)

Power	15W	25W	35W	45W
Rated Input Voltage(V)	AC230V			
Frequency	50/60Hz			
Input Voltage	AC220-240V			
Efficiency	≥85%	≥87%	≥87%	≥87%
Total load wattage	15W±1W	25W±5%	35W±5%	45W±5%
Power Factor	0.9			
Rated Input Current	≤0.1A	≤0.15A	≤0.2A	≤0.25A
Full load output voltage	DC25-42V	DC27-40V	DC25-42V	DC24-40V
Rated output current	350mA	580mA	820mA	1050mA
Output current range	350mA±5%	580mA±5%	820mA±5%	1050mA±5%
Power tolerance	5%			
Current output tolerance	5%			
Short circuit protection	PASS			
Over voltage protection	PASS			
Over temperature protection	PASS			
THD	≤18% @ 230V			
Surge	-			
Withstand voltage	1500V			

## Driver Datasheet (Dimmable)

Power	15W	25W	35W	45W
Rated Input Voltage(V)	AC230V			
Frequency	50Hz			
Input Voltage	AC220-240V			
Efficiency	≥86%	≥87%	≥87%	≥87%
Total load wattage	15W±1W	25W±5%	35W±5%	45W±5%
Power Factor	0.9			
Rated Input Current	≤0.1A	≤0.14A	≤0.2A	≤0.25A
Full load output voltage	DC25-38V	25-38V	25-38V	25-38V
Rated output current	340mA	580mA	820mA	1000mA
Output current range	340mA±5%	580mA±5%	820mA±5%	1000mA±5%
Power tolerance	5%			
Current output tolerance	5%			
Dimming Range	8%-100%			
Short circuit protection	PASS			
Over voltage protection	PASS			
Over temperature protection	PASS			
THD	≤18% @ 230V			
Surge	-			
Withstand voltage	1500V			

# Installation Procedure

## WARNING

1. Switch off before installation.
2. Switch on only after complete installation and examination of the circuit.
3. Professional electrician for installation and maintenance only.

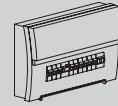

**Turn Off  
Power Supply**

Turn Off power supply before starting any installation. Read instructions & check you have all the tools & accessories to complete the installation correctly.

## How to install

### Step 1

Turn Off power supply before starting any installation. Read instructions & check you have all the tools & accessories to complete the installation correctly.

### Step 2

Prior to locating Adaptor into Track Section make sure it is set in the 'OFF' position & 'Locking Lever' is set in the position shown.

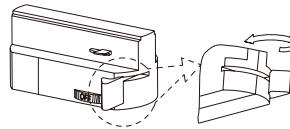

2-wires, 3-wires adaptor

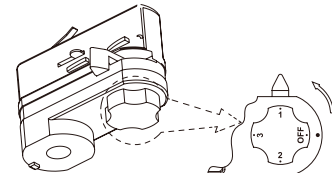

4-wires adaptor

### Step 3

Locate Track Adaptor into Track Section (1) & lock into position by turning 'Locking Lever' 90° (2)

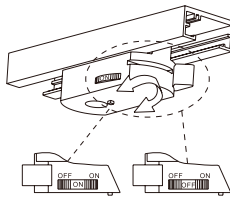

2-wires, 3-wires control luminaires in same circuit by ON/OFF switch.

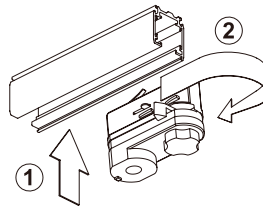

Track Section  
Track Adaptor shown locked into Track Section

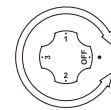

4-wires  
Turn clockwise or anti-clockwise.

### Step 4

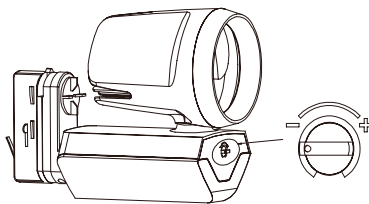

Dimmable button